

# Harpoon™gps

## Owner's Guide

GPS watercraft security, recovery  
and location awareness

## Legal Notices

Blackline GPS Corp. ("Blackline GPS") provides you with installation information to assist you with installation of the Harpoon GPS product. Blackline GPS and its Suppliers will not be liable for any damages, losses of any kind or injury, including lost profits (regardless of whether we have been notified that such loss may occur), arising directly or indirectly from any of the following:

Any damage, loss or injury caused by or to a vehicle, watercraft, aircraft or other property if such damage, loss or injury resulted in connection with the Services or failure of the Services provided by Blackline GPS or the services of the Suppliers; or

Physical injuries, death, or any other damages including loss of profits, loss of earnings, loss of business opportunities, or other loss resulting directly or indirectly out of or in connection with the use of the Services of Blackline GPS or the services, equipment and facilities of the Suppliers.

These limitations of liability apply to acts or omissions of Blackline GPS, its partners, affiliates and Suppliers and each of their respective officers, directors, employees, suppliers, agents, consultants or other persons for whom in law such parties are responsible (together "Representatives"), which would give rise to a cause of action in tort, contract or any other doctrine of law.

© Copyright 2009 Blackline GPS Corp. All rights reserved. Information in this document is subject to change without notice. Blackline GPS reserves the right to change or improve its products and to make changes in the content without obligation to notify any person or organization of such changes or improvements. Visit the Blackline GPS Web site ([www.BlacklineGPS.com](http://www.BlacklineGPS.com)) for current updates and information concerning the use and operation of this and other Blackline GPS products.

The Blackline GPS families of related marks, images and symbols, including Harpoon GPS, MyPass, and Blackline GPS are the exclusive properties and trademarks of Blackline GPS Corp. All other brands, product names, company names, trademarks and service marks are the properties of their respective owners.

This document is provided "as is," and Blackline GPS Corp. ("Blackline GPS") and its affiliated companies and partners assume no responsibility for any typographical, technical or other inaccuracies in this document. Blackline GPS reserves the right to periodically change information that is contained in this document. However, Blackline GPS makes no commitment to provide any such changes, updates, enhancements or other additions to this document to you in a timely manner, or at all.

## FCC Notice

This device complies with part 15 of the FCC Rules. Operation is subject to the following two conditions: (1) This device may not cause harmful interference, and (2) this device must accept any interference received, including interference that may cause undesired operation. Changes or modifications not expressly approved by the manufacturer could void the user's authority to operate the equipment.

## FCC RF Exposure statement

This device is only authorized for use in Mobile applications. At least 20cm (8 inches) of separation between the antenna and the user's body must be maintained at all times. This Class B digital apparatus complies with Canadian ICES-003.

**NOTE:** This equipment has been tested and found to comply with the limits for a Class B digital device, pursuant to part 15 of the FCC Rules. These limits are designed to provide reasonable protection against harmful interference in a residential installation. This equipment generates, uses and can radiate radio frequency energy and, if not installed and used in accordance with the instructions, may cause harmful interference to radio communications. However, there is no guarantee that interference will not occur in a particular installation. If this equipment does cause harmful interference to radio or television reception, which can be determined by turning the equipment off and on, the user is encouraged to try to correct the interference by one or more of the following measures:

- Reorient or relocate the receiving antenna
- Increase the separation between the equipment and receiver
- Connect the equipment into an outlet on a circuit different from that to which the receiver is connected
- Consult the dealer or an experienced radio/TV technician for further assistance

## Welcome!

Getting Started: Harpoon GPS 5

Harpoon GPS Activation 7

Getting Started: MyPass Key Fob 9

Installation Guide 11

Record of Installation 20

Warranty & Customer Care 23

### Welcome!

Thank you for purchasing the Harpoon™ GPS watercraft security, recovery & GPS locator system powered by Blackline GPS™.

**Once installed, please follow these steps to get started:**

- Step 1:** Visit: [www.BlacklineGPS.com/start](http://www.BlacklineGPS.com/start)
- Step 2:** Create a Blackline GPS Network Account, or log into your existing Network Account
- Step 3:** Activate your Harpoon GPS system within your account

**Your Harpoon GPS will be ready to use within eight hours of activation.**

**Step 4:** While waiting for service activation, please configure security alert and notification settings within your account

**Please note:** Your MyPass™ wireless key fob is activated within your account **after** your Harpoon GPS system is active. Activation instructions are provided on page 8 and within your account.

## Harpoon GPS Activation

**About MyPass:** The MyPass key fob automates the arming and disarming of the Harpoon GPS security feature. It is optional, however **required** if you subscribe to the Blackline GPS Monitoring and Recovery Service. In this case, please keep it with you on your keychain.

### Need help?

For helpful resources, please visit: [www.BlacklineGPS.com/support](http://www.BlacklineGPS.com/support)

Helpful information is also available within your network account, located on the **Help** page.

If you have any questions or comments, please contact Blackline GPS Customer Care: [www.BlacklineGPS.com/contact](http://www.BlacklineGPS.com/contact)

Your new Harpoon GPS service must be activated from within your Blackline GPS Network Account.

### To get started:

1. Visit: [www.BlacklineGPS.com/start](http://www.BlacklineGPS.com/start)
2. Create a Blackline GPS Network Account or log into your existing Network Account
3. Activate your Harpoon GPS within your account

**You will need the unit ID and activation code printed below.**

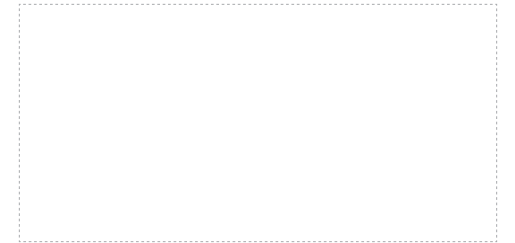

## Getting Started: MyPass Key Fob

If you haven't done so, you **MUST first create your Network Account** and activate your Harpoon GPS with a service plan. Next, your Harpoon GPS **MUST be 'online'** within your Network Account during the pairing process.

### Get started with your MyPass™ key fob:

- Step 1: **Remove** the MyPass key fob battery tab by pulling in the direction of the arrow
  - Step 2: Log into your **Network Account**
  - Step 3: Click on the **Preferences** page
  - Step 4: Click on the **Key Fobs** button
  - Step 5: **Select** your Harpoon GPS from the pick-list
  - Step 6: Enter your MyPass key fob **serial number** (on your MyPass key fob) and a **key fob name** and press the **Add** button
- A status indication will inform you of pairing progress. Pairing can take up to 20 seconds.**
- Step 7: Put your MyPass key fob on your keychain

For more information, read the **MyPass User Guide**, within your Network Account, on the Help page.

### Welcome!

The Harpoon™ GPS watercraft security, recovery & GPS locator device is a state-of-the-art protection solution for your boat or personal watercraft.

Harpoon GPS is conveniently installed in a hidden location within your watercraft. This ensures stealthy operation while continuing to deliver high performance GPS tracking. Harpoon GPS must be hard-wired to a watercraft's 12 VDC or 24 VDC battery system.

### In the box

The following items are included within the Harpoon GPS packaging.

- Documentation kit
- 1 Harpoon GPS device with built-in 2 meter (6.5 feet) power cord
- 1 MyPass™ wireless key fob
- 2 wiring taps (for splicing into watercraft power)
- 1 set of Velcro® mounting fasteners
- 2 mounting screws

## Installation

Blackline GPS recommends that a marine service center perform this work for you. Installation time varies depending on the installation location and your watercraft model. Installation requires approximately 30 to 90 minutes.

**Please read the following installation instructions before you begin.**

## Tools

To install Harpoon GPS, you will need the following tools:

- Test light
- Pliers
- Wire-strippers (optional)
- Phillips #2 Screwdriver (optional)
- Drill with a 1/8" (3mm) bit (optional)

## Choose where to install Harpoon GPS

**Prior to installation, ensure that you and your customer agree upon the Harpoon GPS installation location**

When choosing a location to place the Harpoon GPS device, consider the following:

- Choose a location near 12VDC or 24VDC power
- Choose a location within the watercraft that is **well hidden, but easily accessible for any possible future service**
- **Do not place in an obvious, clearly-visible location**
- For optimum GPS performance, **do not** install below the waterline
- Within a watercraft of metal construction, install in a cabin that is above the waterline and has large windows
- **Do not** completely enclose Harpoon GPS within metal or carbon fiber. This will affect tracking of GPS satellite signals and cellular (wireless) communication
- Harpoon GPS must be installed inside the **interior of the watercraft**
- Harpoon GPS **does not need to be mounted in direct view of satellites**
- You **may mount Harpoon GPS behind** plastic panels, under upholstery, and behind wood, fiberglass or fiber-board
- Mount Harpoon GPS so its top side (with the logo and button) **faces away from the mounting surface** and toward the interior of the watercraft (it's okay to be mounted upside down, if needed)

- For optimum GPS performance, it is critical that there is a minimum of **6" of clearance** between the Harpoon GPS enclosure top and metallic surfaces/objects
- **Never** install Harpoon GPS in a location that could interfere with the operation of safety systems

## Hardwiring Harpoon GPS

Harpoon GPS is hardwired to the watercraft's power system with its built-in 2m (6.5') power cable. Harpoon GPS is compatible with both **12 VDC** and **24 VDC** watercraft power systems. Harpoon GPS **must** be wired to a continuous source of power that is not controlled by the ignition key. This ensures the internal **back-up battery is fully charged at all times**.

Harpoon GPS consumes approximately 20 mA of current at 12 VDC. This is a small current draw, and is not sufficient to drain the watercraft's battery provided that the watercraft is used (and power system charges its battery system) regularly.

Harpoon GPS features an internal fuse – an external fuse is not typically required. Please read the important notice below relating to use of an external fuse.

### **IMPORTANT: to protect against fire hazard**

When wiring the Harpoon GPS to a non-fused circuit, such as directly to the battery, you must install a 5 AMP fuse in-line with the positive connection. The fuse should be installed at the connection point of the Harpoon GPS positive wire and the watercraft's power supply.

## The easiest method to hardwire Harpoon GPS is as follows:

- Using the test light, identify a **non-switched 12V / 24V wire** (a wire not controlled by the ignition key). **Please note:** Harpoon GPS consumes up to 1A peak current in very short bursts.
- **Disconnect the negative connection to the watercraft's battery**
- Route the positive wire to the non-switched 12V / 24V wire
- Route the negative wire to a watercraft electrical system ground
- Place one of the supplied wiring taps over the watercraft's non-switched 12V / 24V wire
- Insert Harpoon GPS's **un-stripped positive wire** into the wiring tap (**see #1 in illustration**)
- Use pliers to **compress the U-contact blade**, connecting the two wires (**see #2 in illustration**)
- Close the hinged top cover until securely latched (**see #3 in illustration**)
- Using the second wiring tap, repeat the same process for the ground wire

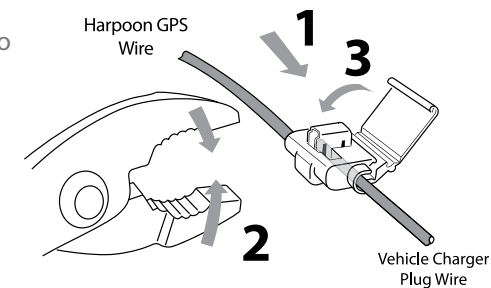

## Other methods to hardwire Harpoon GPS include:

- Wiring Harpoon GPS directly to the watercraft's battery terminals. This is an advanced technique, and not described within this guide (please read the important notice on page 18)
- Hardwiring Harpoon GPS to the watercraft's power system using soldering techniques. Soldering techniques are not described within this document. Consult an installation professional for more information

## Verifying installation

### Verifying Installation

To verify the installation at any time after the Harpoon GPS has been connected to power:

- Ensure that the **ignition key is in the off position**
- Wait 5 seconds and then **press and release** the blue power button

If the power cable has been **correctly connected**, the green indicator light will either blink slowly or turn on continuously for 2 minutes.

If the power cable has been **incorrectly connected**, either no indicator lights turn on or the red and green indicator lights will blink rapidly for 5 seconds. In this case:

- Power is not connected, or
- Power is connected with the incorrect polarity, or
- The circuit is controlled by the ignition key

Adjust the electrical connection, and verify again.

## Harpoon GPS indicator light sleep mode

Harpoon GPS features a status indicator light sleep mode to ensure stealth operation. After a few minutes, the indicator lights will automatically turn off while the device continues to operate. To awaken the status lights, press the blue power button once and release.

## Mounting Harpoon GPS

**There are two methods to mount Harpoon GPS. The first uses the supplied Velcro fasteners:**

- Ensure that the watercraft mounting surface is clean and dry
- Adhere the mated pair of Velcro fasteners to Harpoon GPS as shown below (do not separate the Velcro-mated pair)
- Peel the adhesive backing and press Harpoon GPS into place—**to allow adhesive to set, do not remove for 24 hours**

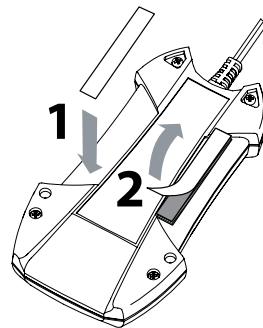

**The second mounting method uses the supplied screw fasteners:**

- Use the Harpoon GPS enclosure as a template to mark the screw locations on the mounting surface
- Pre-drill screw holes with a 1/8" (3mm) drill bit
- Holding the Harpoon GPS enclosure over the pre-drilled holes, fasten it into place using the screws and a screw driver
- Tighten the screws until they are firmly in place. **Do not over-tighten**

Helpful information is available at [www.BlacklineGPS.com/support](http://www.BlacklineGPS.com/support). Additional resources are available online from within your network account located on the Help page.

### **IMPORTANT: environmental considerations related to installation**

Your Harpoon GPS operates from -20 °C to +55 °C (-4 °F to 131 °F) and is protected against dust and water spray. Ensure that your Harpoon GPS is mounted in a protected location inside your vehicle and away from sources of heat. **DO NOT OPERATE HARPOON GPS IN DIRECT SUNLIGHT.** In the event of an over or under-temperature condition, Harpoon GPS may go offline within your Network Account. Upon returning to within normal operating temperatures, Harpoon GPS will reconnect to the wireless network and come online within your Network Account.

### **TIP: Minimizing buzzing in audio speaker system**

To minimize occasional buzzing induced into your vehicle's audio speaker system from Harpoon GPS wireless communication, mount Harpoon GPS 12 inches away from audio system components and wiring.

# Record of Installation

## ATTENTION INSTALLER

When installing the Harpoon™ GPS system for your customer, please:

1. Carefully read the included Harpoon GPS installation guide in detail
2. Install Harpoon GPS per the installation guide
3. Complete the included Harpoon GPS Record of Installation card
4. Place the Harpoon GPS installation record card at the back of the other documents within the Harpoon GPS documentation kit
5. Return all packaging and materials to the customer

Thank you!

# Harpoon GPS Installation Record Card

Watercraft year: \_\_\_\_\_ Installation date: \_\_\_\_\_

Watercraft make: \_\_\_\_\_ Installation company: \_\_\_\_\_

Watercraft model: \_\_\_\_\_ Technician name: \_\_\_\_\_

Hull Identification Number (HIN): \_\_\_\_\_ Harpoon™ GPS Unit ID: \_\_\_\_\_

## Installation location

Please mark location

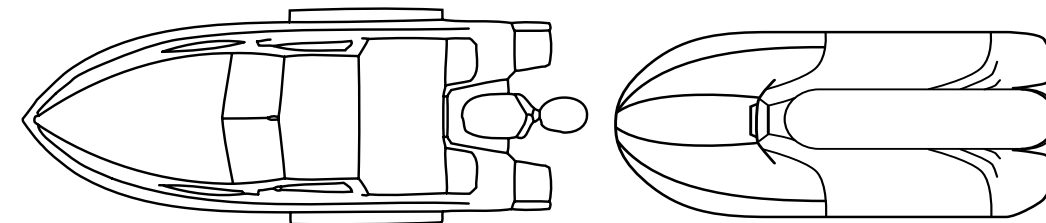

Location Description: \_\_\_\_\_

\_\_\_\_\_  
\_\_\_\_\_

**PLEASE DO NOT RETURN TO THE STORE!**

Should you have any questions or problems related to your Harpoon GPS please contact the Blackline GPS Customer Care team.

Contact information is available online at:

**[www.BlacklineGPS.com/support](http://www.BlacklineGPS.com/support)**

**Warranty**

Your Harpoon GPS is warranted against defects in materials and workmanship for up to one year from date of purchase. The MyPass™ key fob is not warranted against water damage and is not water resistant. Use the enclosed floater when on or near water. For further details regarding your Blackline GPS warranty, please refer to your Terms & Conditions of Service provided at time of activation and available anytime from within your network account.

Tell us what you think!

**Your satisfaction matters to us. Please take  
a few moments to tell us what you think.**

**[www.BlacklineGPS.com/feedback](http://www.BlacklineGPS.com/feedback)**